



THE CLYDE

POWERED BY Sweetwater

Box Office / Shipping Address / Venue Address

The Clyde Theatre, 1808 Bluffton Road
Fort Wayne, IN 46809 1-260-747-0989

Loading Dock / Van & Trailer / Bus Parking

Same address. Pull to the back of the building to access loading docks and production lot. See map below

Please note box office hours for shipments

Monday to Friday 10am to 6pm or Saturday and Sunday
2 hours prior to doors on event days only

GPS Coordinates

42.963595, -85.6727

CONTACT LIST

General Manager

Rick Kinney
1-260-442-8181
rick@clydetheatre.com

Production Manager

Shawn Dealey
1-260-710-0013
shawn@clydetheatre.com

Box Office Manager

Sara Williams
sara@clydetheatre.com

Programming & Marketing Director

Brooke Klejnot
1-317-956-9011
brooke@clydetheatre.com

In House Buyer & Booking Coordinator

Scott Hammontree
1-616-890-0226
scott@sectionlive.com

Hospitality Coordinator

Kat Bowser
1-260-579-5884
kat@clydetheatre.com

PARKING INFORMATION

The Clyde is located at 1808 Bluffton Rd Fort Wayne, IN 46809 between Broadway and Brooklyn Ave. There are designated spots in our parking lot for artist buses and production trucks. See floor plan page

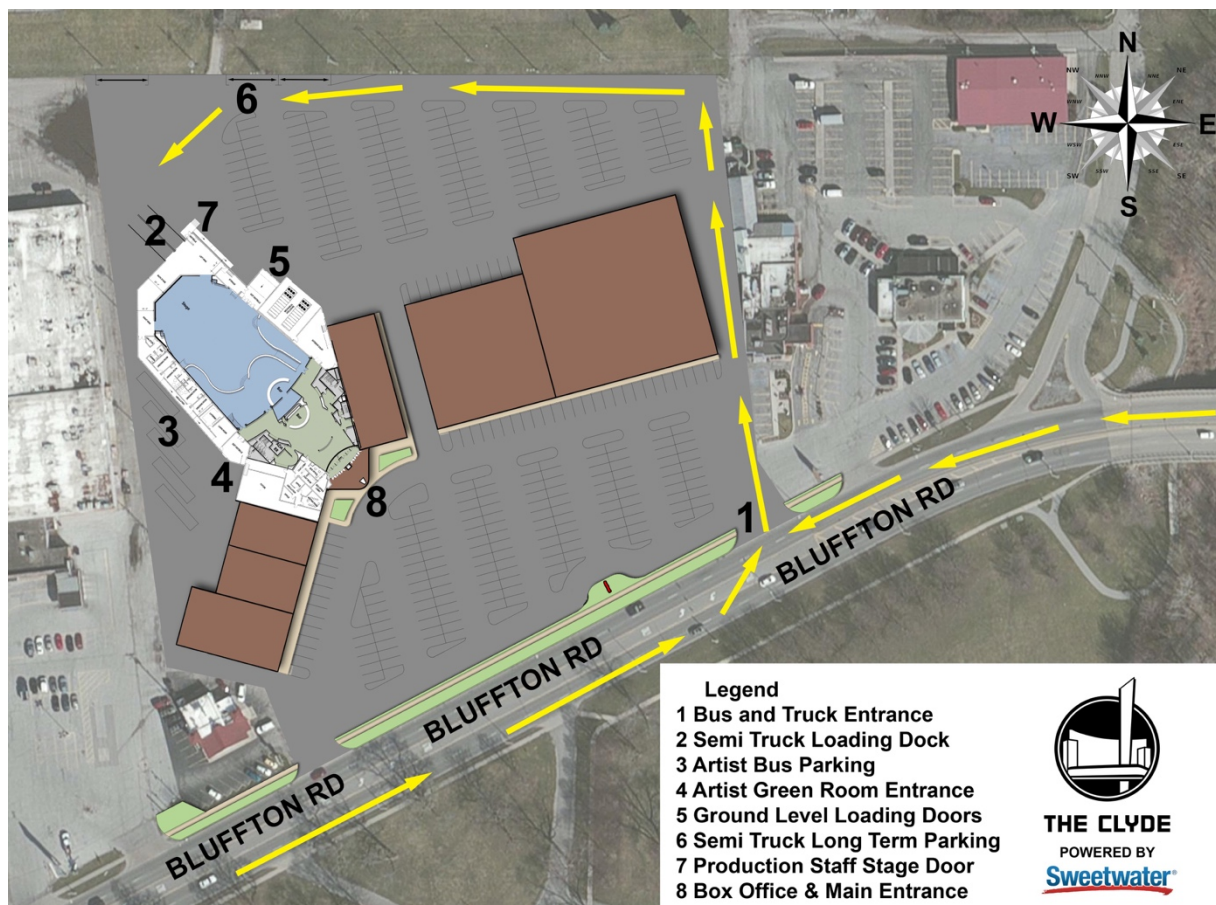

LOADING DETAILS	Access from two sealed truck docks at stage level – 20’ push
STAGE ACCESS	All semi-trucks will unload at loading docks located at the back of the building Buses w/ Trailers unload on the east side of the loading dock on wheelchair ramp
LOADING DOOR DIMENSIONS	Loading dock door: 13’10” high x 8’ wide
STAGE WIDTH	70’ downstage 38’ between Drapes 38’ upstage
STAGE DEPTH	32.5’
STAGE HEIGHT	4’
STAGE TYPE	The stage is comprised of concrete
TRIM HEIGHT	27’ to truss
GRID HEIGHT	31.5’ from floor to steel beams
RISERS	Risers can be rented per advance no later than two weeks before event date
DEAD CASE STORAGE	Dead cases will live in the indoor staging area behind upstage wall
DISTANCE TO FOH	70’
CABLE RUN TO FOH	100’ – All cable will run through 12” cable conduit from stage to FOH. Floor access vault doors located center of house at downstage lip and FOH location.

GUEST / HOUSE / STAGE POWER

RATING	LOCATION	TERMINATION	USER
Lighting 400 AMP / 3 Phase 120/208	Upstage Right 10’ – Pass through on lighting distro	Camlock	House Lights/Touring Lights/Video
Sound 200 AMP / 3 Phase 120/208	Downstage Left 10’	Camlock	Touring Audio

Audio Specifications

Left/Right Main PA

20x JBL VTX A12 Dual 12" Line Array Loudspeaker

Subs

8x JBL VTX G28 Dual 18" Subwoofer under stage

Front Fill

7x JBL VT4886 Subcompact Passive Three-Way Line Array

Delay

5x JBL VRX 932LA 12" Bi-Amplified 2-Way Line Array

Amps

14x Crown I-Tech 4x3500HD Four-channel, 4000W @ 4Ω
4x Crown I-Tech 12000HD Two-channel, 4500W @ 4Ω 1x
BSS London Soundweb BLU -160

Stage Monitoring

8x JBL VTX M22 Dual 12" Stage Monitor(8 more available by request)

2x JBL VTX F35/95 Dual 15" 3-Way Loudspeaker

1x JBL VTX F18S 18" Compact Single Subwoofer

Audio Consoles

Avid Venue S6L-32-192 x2 FOH/monitors

Venue Stage 64 - 64 analog in/24 analog out/8 digital out

Wireless

4 - Axient AD4DUS

8 - Axient AD2 w/ 4x SM58, 4x KSM8 2x M81WH

4 - P10T--G10

8 - P10R--G10

Microphones

Shure

8 - SM57, 2 - Beta57A, 4 - SM58, 2 - Beta58A, 2 - Beta181,

2 - Beta87A, 4 - KSM141, 6 - Beta98AMP, 4 - KSM32,

2 - KSM44A, 2 - Beta52A, 2 - Beta91A, 1 – Beta98H

Telefunken

2x M81 WH

4x M81-SH, 1x M80-SH, 3x M60Fet

1x M82

Sennheiser

4x 421MD, 2x e906, 4x e945

Radial

4x JDI, 4x J48, 4x JDI Stereo

Full complement of K&M Microphone Stands

Lighting Specifications

Eurotruss Pre Rig Trussing
Stage Maker Chain Hoists

Martin
Mac Quantum Profile x5
Mac Quantum Wash x8
Rush PAR2 x24

Chamsys MQ500 Stadium Console

Chauvet
Chauvet Professional Amhaze Stadium Hazer x2

BACKLINE, LABOR, SPECIAL EFX AUDIO INFORMATION

BACKLINE LABOR

There is no backline in house.
The Clyde is a non-union venue. Our house crew will act as loaders, stagehands and technicians upon request. Please advance all labor needs at least two weeks in advance.

RIGGING

Riggers are provided per advance. A manlift must be rented to do any rigging on stage. Rigging details available per advance.

FORKLIFT CONFETTI

There is no forklift available onsite
Biodegradable confetti is permitted. Mylar and metal confetti are not permitted.
There is a \$500 cleanup charge for all confetti.

CRYO PYRO

Please give Production Manger 5 days notice if you require CO2.
Pryo and open flame are permitted at The Clyde but must be advanced and obtain prior approval in writing by General Manager. A permit from City of Fort Wayne Fire Dept. is required. The permit process may take some time so please contact Production Manager as soon as possible regarding any pyro requirements.

HAZE

The Production Manager must be notified before any haze can be used in the building, including rehearsals and sound check.

SOFT GOODS SPOT LIGHTS

Any draperies, banners and backdrops must have active fire certificate
There are no spot lights in house. Spotlights can be rented and supplied by venue upon request.

SECURITY, CREDENTIALS, MEET & GREETES, SETTLEMENT, AND CAMERA POLICY

SECURITY

To provide the most safe and comfortable experience for our artists and guests, all working personnel, guests, and artists will be expected to pass through a metal detector when entering the building. Your privacy and individuality are of the utmost importance to us so please understand our only concern is preventing weapons from entering the building. Our backstage is your home and we encourage you to go about your business as you would anywhere else. Please let the Production Manager know if you have any questions regarding the metal detector or any security procedures at The Clyde.

SECURITY MEETING

A security meeting will take place 1 hour prior to doors with the venue GM, Production Manager, and tour representative.

CREDENTIALS

The Clyde will honor touring credentials and can provide house passes upon request. All artist, crew, and guests must provide identification to obtain a drinking wristband. Indiana state law stipulates that only people over the age of 21 years old with valid I.D. may consume alcohol beverages. Please inform venue Production Manager if there is an underage person in your touring party.

GUEST LIST

All guest list names must be turned in no later than 30 minutes prior to doors opening to the Box Office manager.

V.I.P. or MEET & GREET	All Meet & Greet, V.I.P. and Early Entries must be advanced with the Production Manager two weeks prior to show. There is a \$200 fee associated for all V.I.P., early entry and/or meet & greets that require extra security/staff.
PHOTO POLICY	We honor all touring policies. We can provide photo passes upon request.
VIDEO POLICY	Any filming crew or video shoot details must be advanced two weeks prior to the show. A release must be signed for any video recording.
BARRICADE	We have MOJO style barricade in house for the front of the stage and FOH area.
SETTLEMENT	All cash requests must be made two weeks in advance. No cash is on hand unless otherwise advanced.

CATERING, HOSPITALITY, MERCHANDISE, RUNNERS

CATERING	The Clyde does not have kitchen facilities; however, we do have a list of preferred caterers to fill catering needs with advanced notice.
HOSPITALITY	All hospitality needs are to be advanced with the Production Manager/Hospitality Coordinator and is per budget unless otherwise noted. Please send all hospitality riders two weeks prior to your show during production advance.
DRESSING ROOMS	We have 4 private dressing rooms and 1 green room/common area located on the main floor backstage. Dressing room curfew is 2 hours after show ends.
DIMENSIONS	# 1 dressing room 14' wide x 20' deep # 2 dressing room 22' wide x 20' deep # 3 dressing room 20' wide x 22' deep # 4 dressing room 14' wide x 20' deep #5 artist lounge 40' wide x 20' deep
DRESSING ROOM ACCESS	Dressing rooms are accessed backstage and by entrance in bus lot.
SHOWERS	Dressing room #2 and #3 have showers.
LAUNDRY	We have a washer and dryer located backstage in utility closet.
WIFI	Password Located on walls in dressing rooms
CATERING / CREW	There is an artist/crew lounge and catering room located next to dressing room #4
RUNNERS	All runners are per advance. All runners are in personal vehicles. Any vehicle rentals will be at artist cost.
RESTAURANTS	We have a menu book in each green room and are located just southwest of downtown Fort Wayne.
MASSAGE THERAPISTS	Please let us know if you are in need of a massage therapist and we can connect you to a certified massage therapist.
EMT / MEDICAL / POLICE	We will have one EMT on staff unless otherwise noted. Police are on site only on an as needed basis or per advance.
MERCHANDISE	We retain 7% sales tax on all goods sold. The house cut is per contract. Our house seller is \$100 flat rate. Please advance with the PM if you are in need of a seller. Our in-house merchandise representative will count in / out for each show. Please let us know if you have a specific time you'd like to count in.



Visit our partners at Sweetwater Pro Audio and Musical Instruments while in town, located just 7 miles from the Clyde Theatre at 5501 US-30 w Fort Wayne, IN 46818 (800) 222-4700

CLYDE THEATRE DRESSING ROOM & FLOOR PLAN

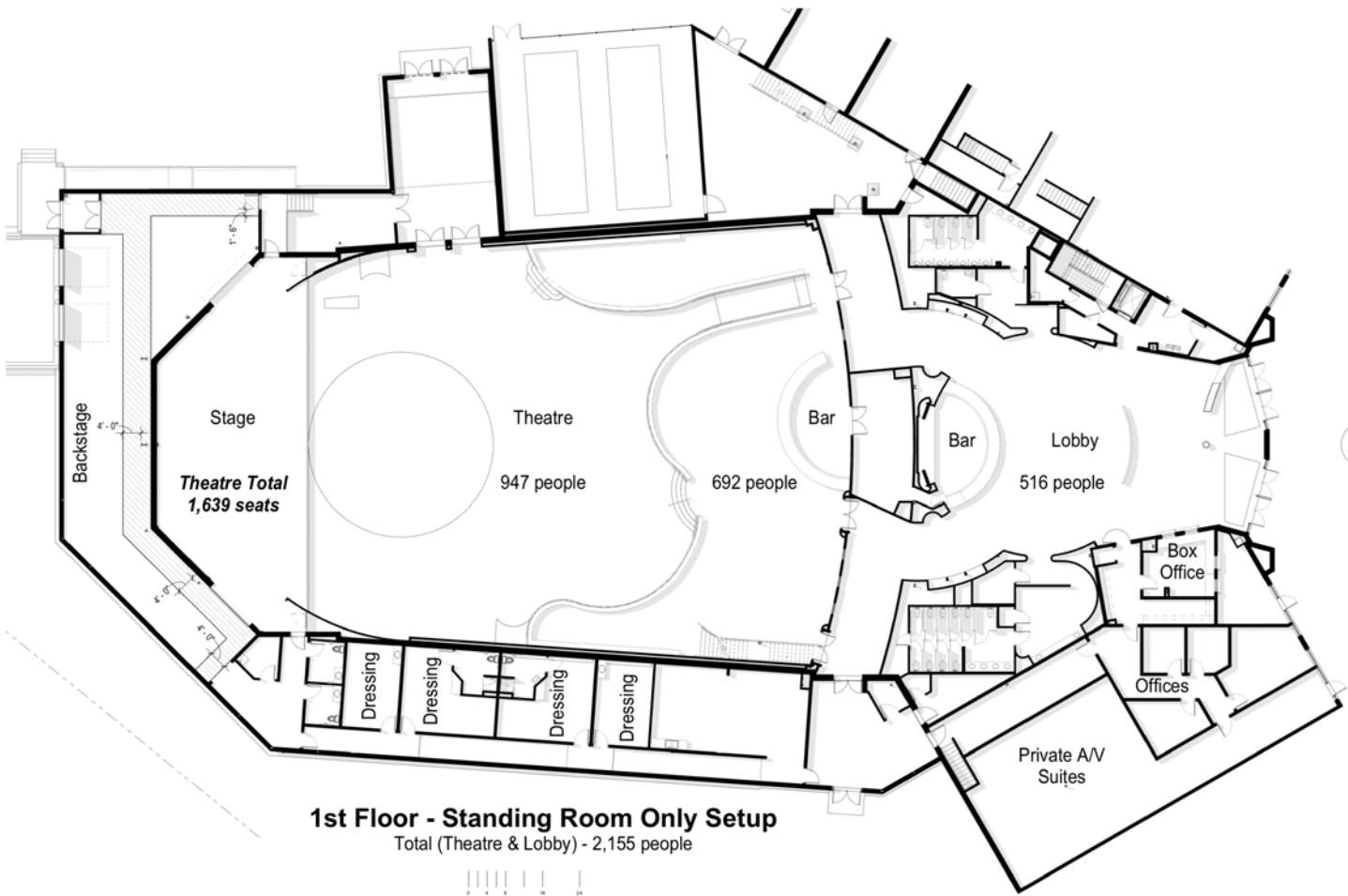

HOTEL RECOMMENDATIONS

**Wyndham Garden Hotel
Zoe Fitzgerald
Director of Sales
5750 Challenger Parkway
Fort Wayne, IN 46818
Phone: 260-999-6040
Mobile: 260-443-4084
Email: zfitzgerald@wyndhamgardenfw.com**

